

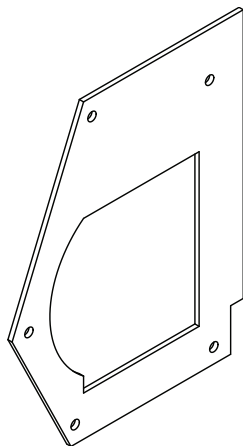

INSTALLATION OF AN EXHAUST FAN FOR A KOZI FREE STANDING PELLET STOVE

PARTS NEEDED:



GKT00209

EXHAUST FAN MOUNTING
(5-SIDED) GASKET

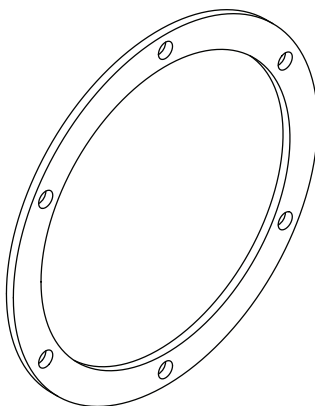

GKT00208

EXHAUST FAN
MOTOR GASKET

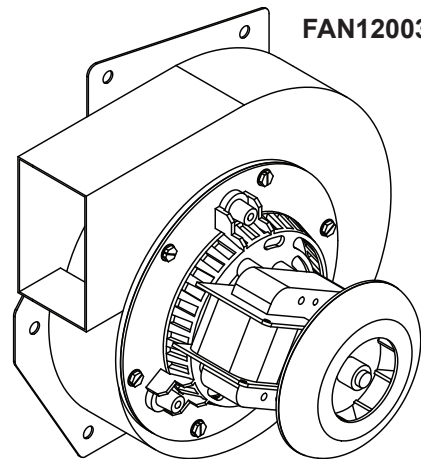

FAN12003

EXHAUST FAN
ASSEMBLY

TOOLS REQUIRED:

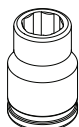

1/4" & 3/8"
SOCKET

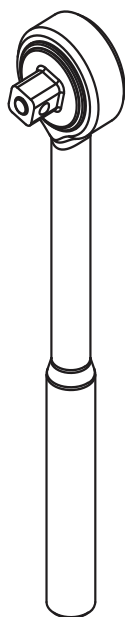

SOCKET
WRENCH

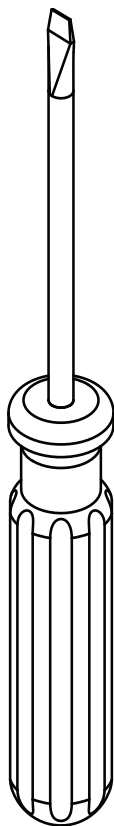

FLATHEAD
SCREWDRIVER

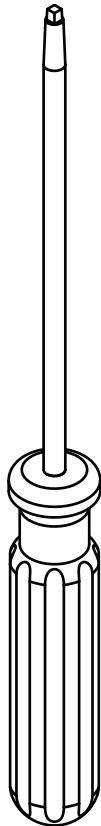

#2 ROBERTSON
SCREW DRIVER

***NOTE:**

THERE ARE 2 DIFFERENT WAYS
TO REPLACE YOUR EXHAUST FAN
ASSEMBLY:

METHOD 1. SWAPPING JUST THE
EXHAUST FAN MOTOR ASSEMBLY.

METHOD 2. SWAPPING OUT THE
ENTIRE EXHAUST FAN ASSEMBLY.

THE SIMPLEST METHOD IS TO JUST
SWAP THE FAN MOTORS. HOWEVER,
IN SOME CASES THE ENTIRE
EXHAUST FAN ASSEMBLY SHOULD BE
REPLACED (i.e. DAMAGED HOUSING,
DAMAGED EXHAUST FAN MOUNTING
GASKET, etc.)

FOLLOW STEP 1 & 2 TO OPEN SIDE
PANEL. FOLLOW STEPS 3 - 7 FOR
METHOD 1. FOLLOW STEPS 8 - 15
FOR METHOD 2. FOLLOW STEPS 16 -
17 TO CLOSE SIDE PANEL.

OPENING THE LEFT SIDE PANEL TO ACCESS THE EXHAUST FAN:

1

PULL THE DAMPER ALL THE WAY OUT. REMOVE THE SPRING COIL HANDLE ON THE DAMPER BY PULLING ON THE SPRING AND ROTATING IT CLOCKWISE SIMULTANEOUSLY AS SHOWN BELOW.

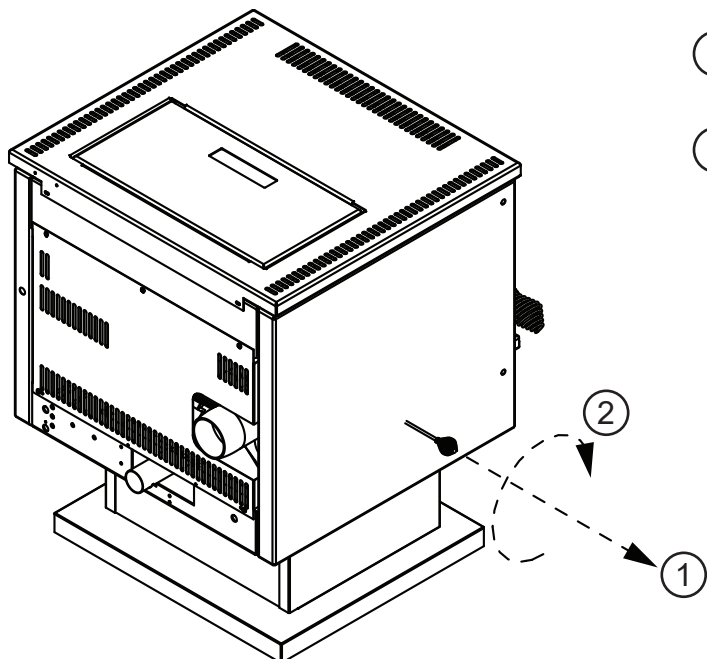

① PULL THE DAMPER ALL THE WAY OUT.

② ROTATE THE SPRING COIL HANDLE CLOCKWISE AND PULL AT THE SAME TIME. THE SPRING COIL HANDLE WILL “UNSCREW” ITSELF OFF OF THE DAMPER ROD.

2

REMOVE THE SCREWS SECURING THE SIDE PANEL IN PLACE. ONCE THE SCREWS HAVE BEEN REMOVED, SWING THE SIDE PANEL OPEN.

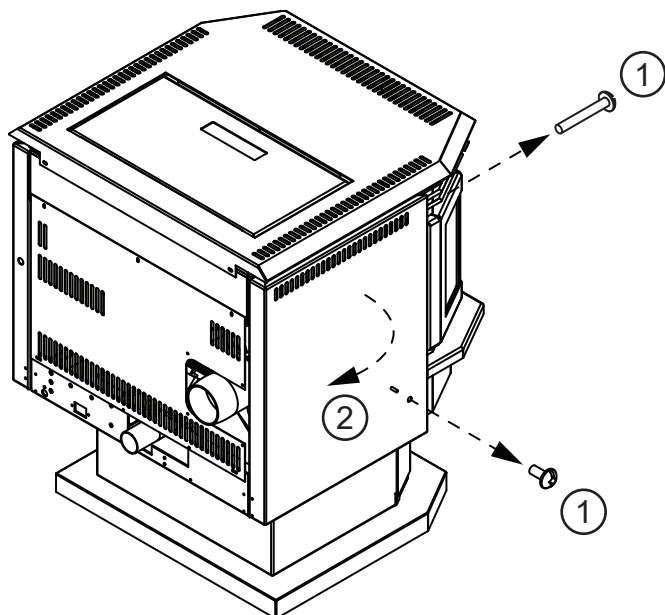

BAYWIN

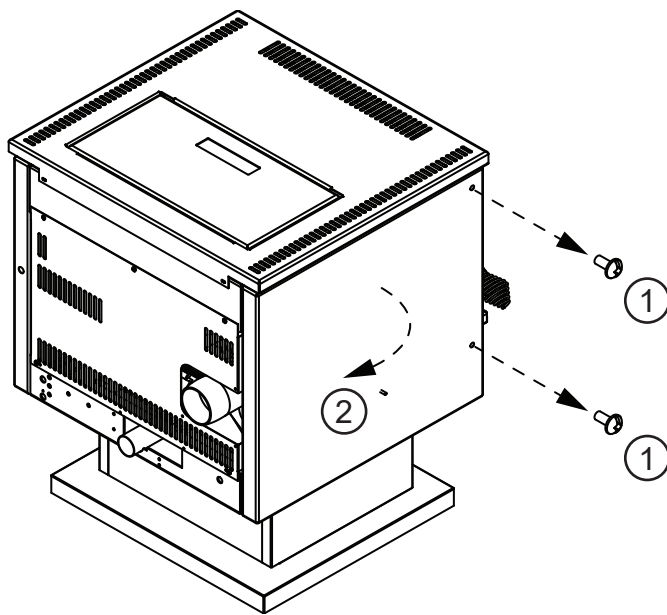

MODEL 100

CONTINUED

2

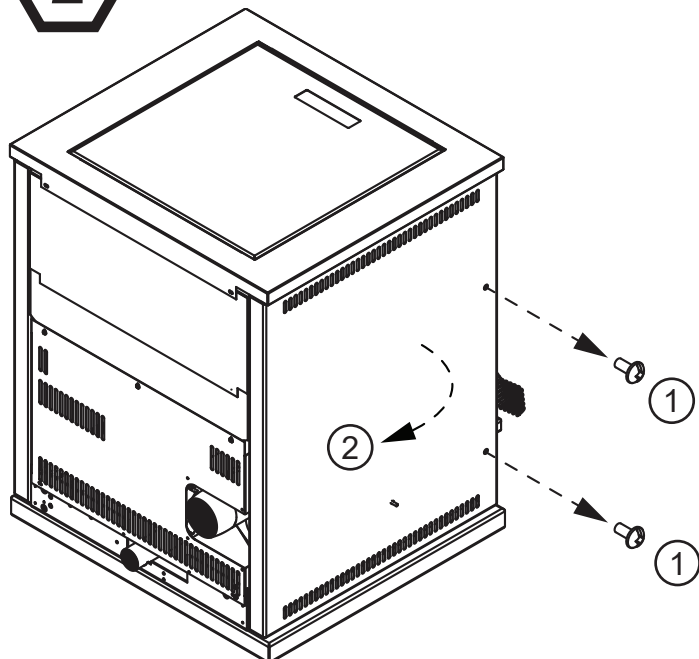

KSH 120

- ① REMOVE THE SCREWS SECURING THE SIDE PANEL IN PLACE. USE A #2 ROBERTSON SCREWDRIVER.

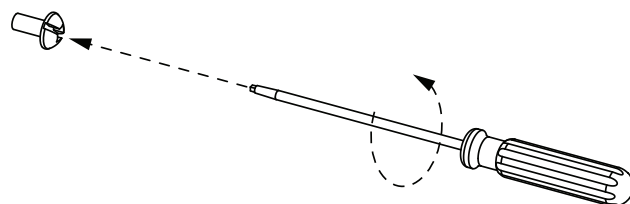

- ② ONCE THE SCREWS ARE REMOVED AND THE DAMPER IS FULLY CLOSED, SWING THE SIDE PANEL WIDE OPEN TO ACCESS THE EXHAUST FAN.

METHOD 1: REPLACING EXHAUST FAN MOTOR AND BLADES ONLY

3

WITH THE SIDE PANEL OPEN, LOCATE THE 6 SCREWS IN A CIRCULAR PATTERN SECURING THE EXHAUST FAN MOTOR TO THE HOUSING. REMOVE ALL 6 SCREWS AS SHOWN BELOW.

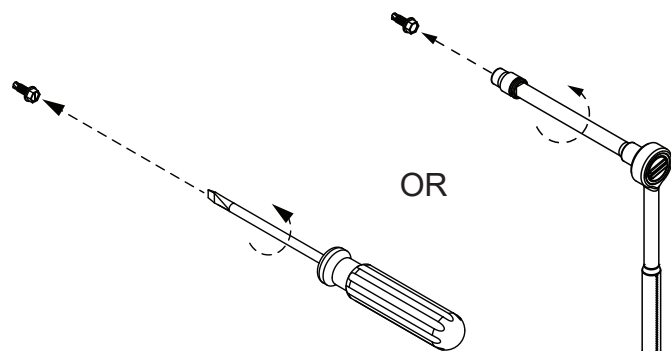
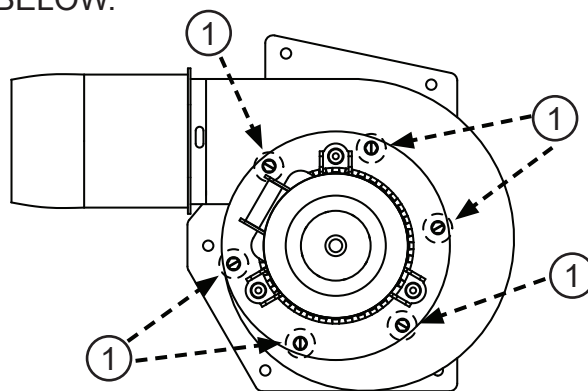
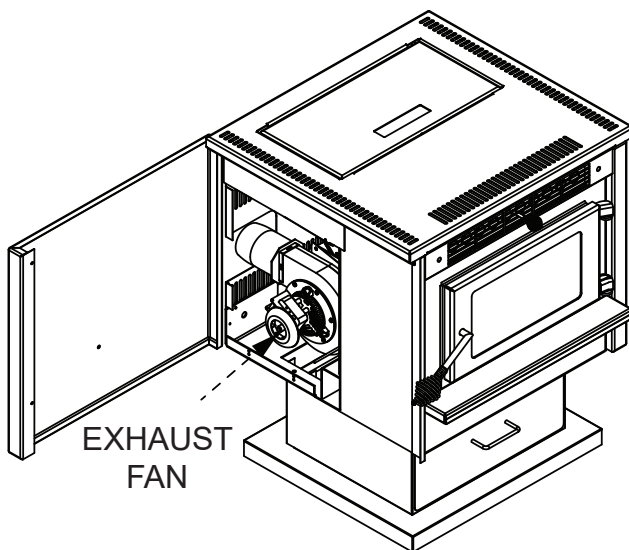

OR

4

DISCONNECT THE EXHAUST FAN WIRES FROM THE MAIN WIRING HARNESS OF THE PELLET STOVE AS SHOWN BELOW.

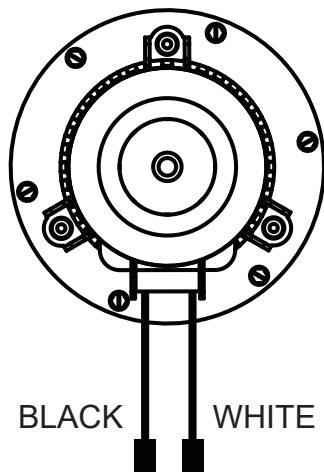

BLACK WHITE

BLUE WHITE

MAIN HARNESS

MX OR MX2 CONTROL BOARD

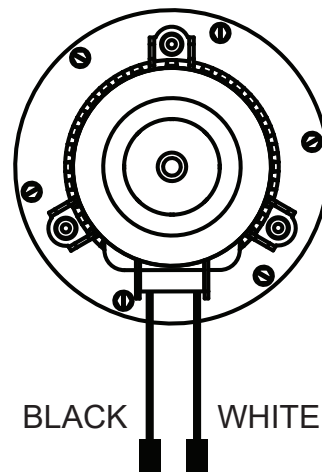

BLACK WHITE

RED WHITE

MAIN HARNESS

STANDARD CONTROL PANEL

5

REMOVE THE ROUND, EXHAUST FAN GASKET AND EXHAUST FAN MOTOR FROM THE NEW ASSEMBLY BY REMOVING THE 6 SCREWS AS SHOWN BELOW.

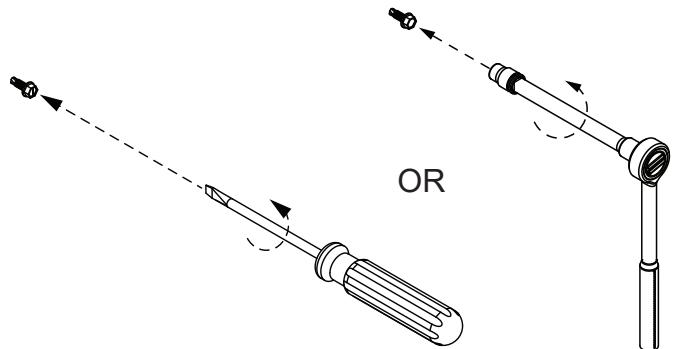
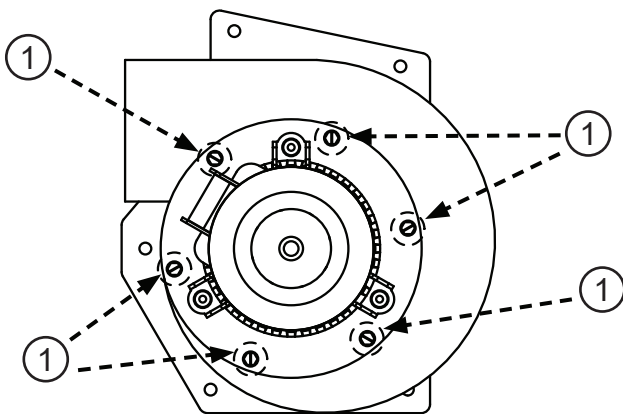

① REMOVE THESE 6 SCREWS USING A FLAT HEAT SCREW DRIVER OR A 1/4" SOCKET AND SOCKET WRENCH.

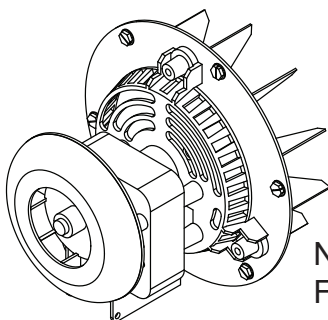

NEW EXHAUST
FAN MOTOR

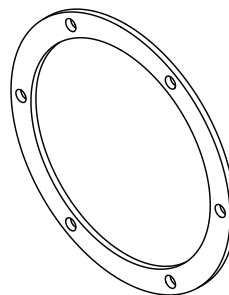

NEW EXHAUST
FAN MOTOR
GASKET

6

REMOVE THE ROUND, EXHAUST FAN GASKET AND EXHAUST FAN MOTOR FROM THE NEW ASSEMBLY BY REMOVING THE 6 SCREWS AS SHOWN BELOW.

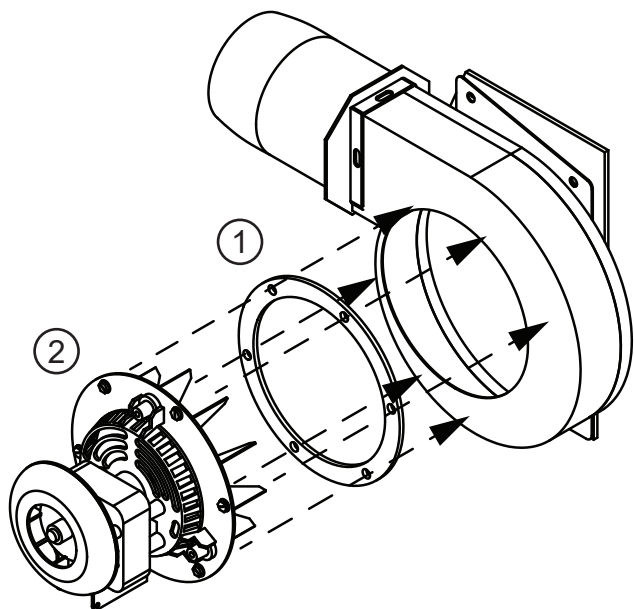

- ① PLACE EXHAUST FAN MOTOR GASKET ON THE EXHAUST FAN HOUSING.
- ② PLACE EXHAUST FAN MOTOR NEXT AND SECURE THE MOTOR AND GASKET TO THE HOUSING WITH THE 6 SCREWS REMOVED IN STEP 5. SECURE THE SCREWS WITH THE FLAT HEAD SDCREWDRIVER OR a 1/4" SOCKET AND SOCKET WRENCH..

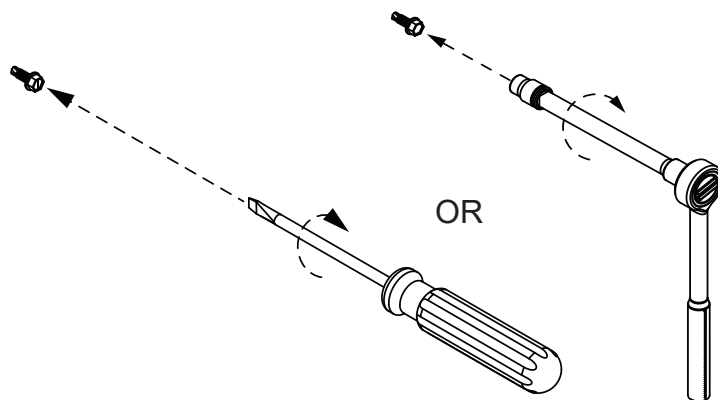

7

CONNECT THE EXHAUST FAN WIRES TO THE MAIN WIRING HARNESS OF THE PELLET STOVE AS SHOWN BELOW.

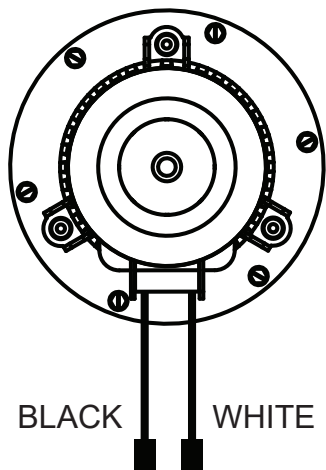

BLACK WHITE

BLUE WHITE

MAIN HARNESS

MX OR MX2 CONTROL BOARD

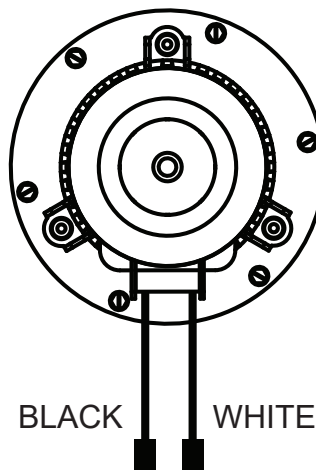

BLACK WHITE

RED WHITE

MAIN HARNESS

STANDARD CONTROL PANEL

METHOD 2: REPLACING ENTIRE EXHAUST FAN ASSEMBLY.

8

ONCE THE SIDE PANEL IS OPEN, DISCONNECT THE EXHAUST VENTING FROM THE STOVE AND PULL THE STOVE AWAY TO ACCESS THE BACK.

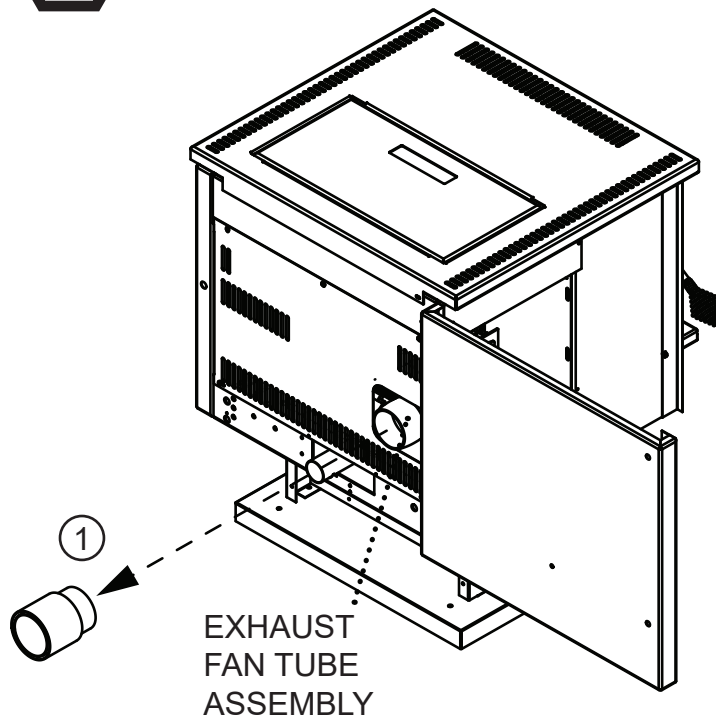

- ① REMOVE THE FIRST PIECE OF VENTING THAT IS ATTACHED TO THE EXHAUST FAN TUBE ASSEMBLY. TYPICALLY THIS WILL BE A PIPE ADAPTER.

9

REMOVE THE BACKPLATE OF THE STOVE WITH A #2 ROBERTSON SCREWDRIVER AS SHOWN BELOW.

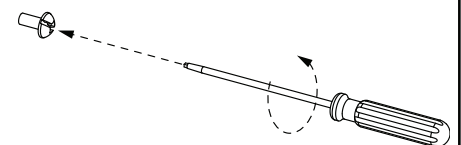
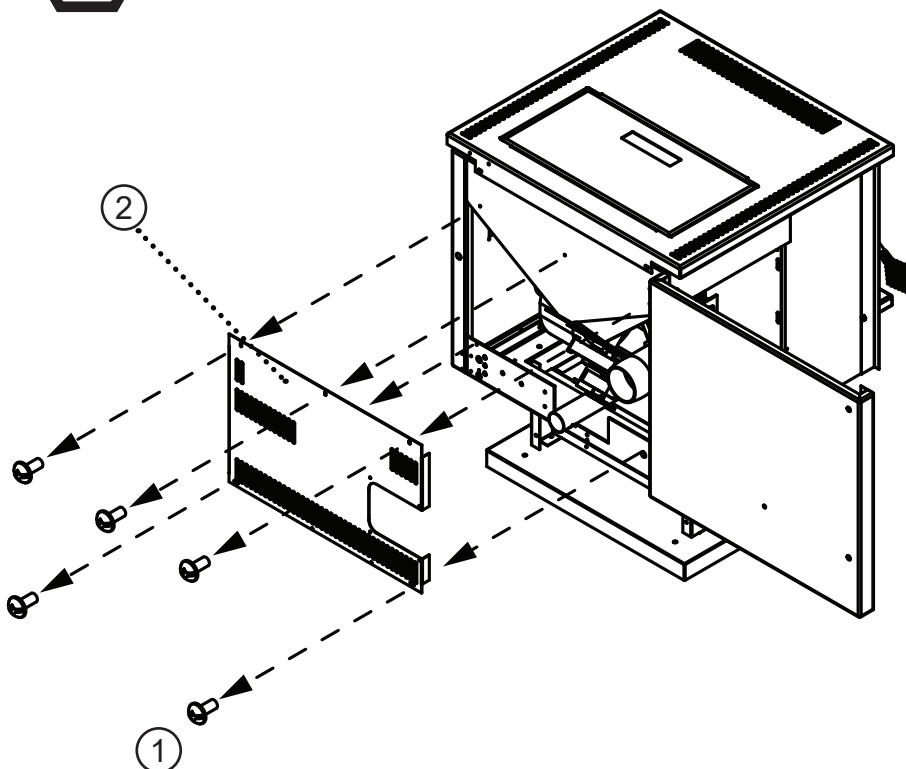

- ② PULL THE BACK PLATE AWAY FROM THE STOVE.

10

REMOVE THE 5 BOLTS SECURING THE ENTIRE EXHAUST FAN ASSEMBLY TO THE PELLET STOVE.

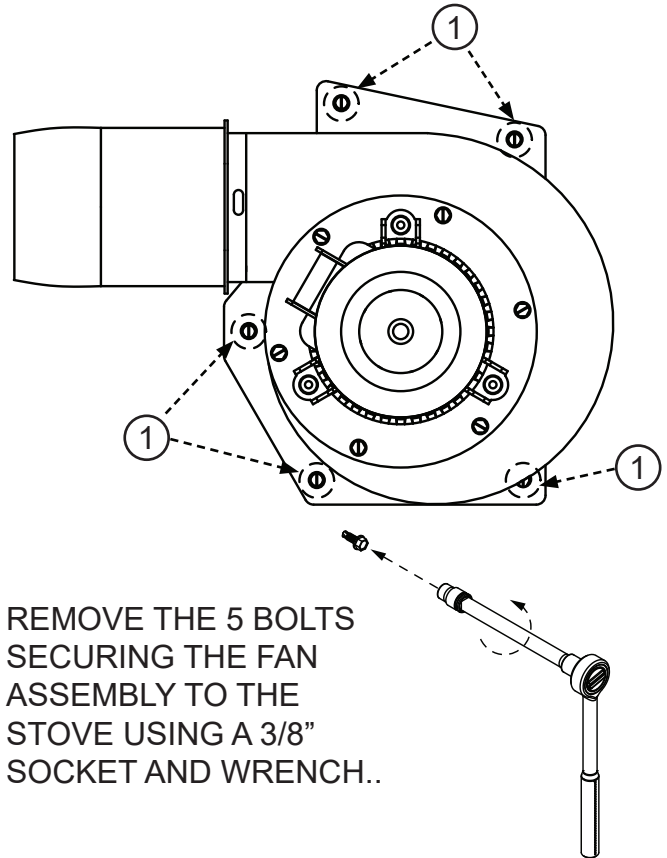
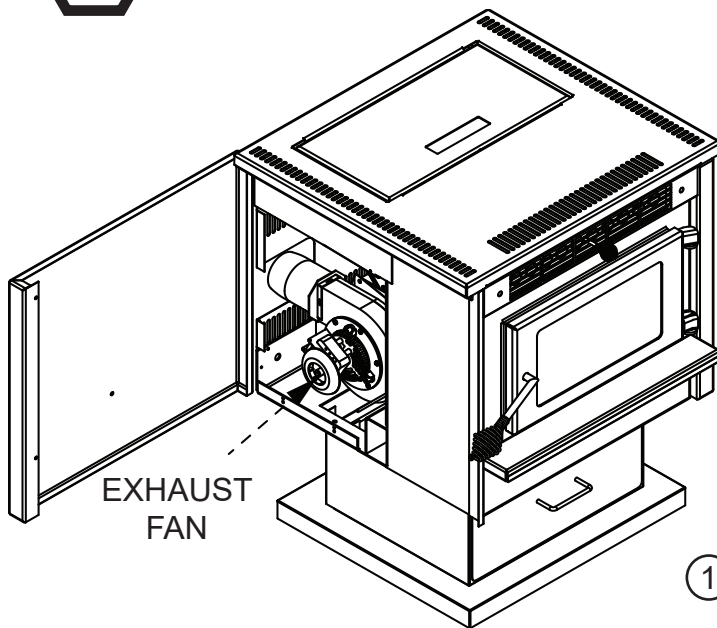

11

DISCONNECT THE EXHAUST FAN WIRES FROM THE MAIN WIRING HARNESS OF THE PELLET STOVE AS SHOWN BELOW.

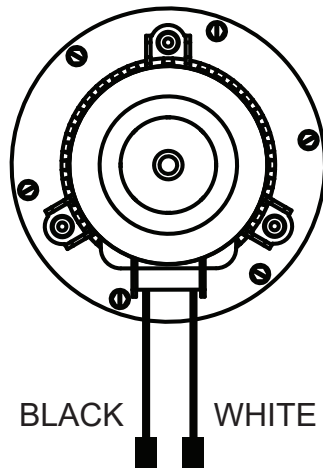

BLUE WHITE

MAIN HARNESS

MX OR MX2 CONTROL BOARD

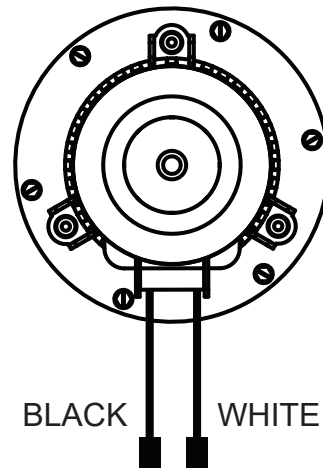

RED WHITE

MAIN HARNESS

STANDARD CONTROL PANEL

11

PULL THE EXHAUST FAN ASSEMBLY OUT OF THE STOVE AND REMOVE THE 4 SCREWS SECURING THE TUBE ASSEMBLY TO THE FAN HOUSING AS WELL AS THE EXHAUST FAN MOUNTING GASKET.

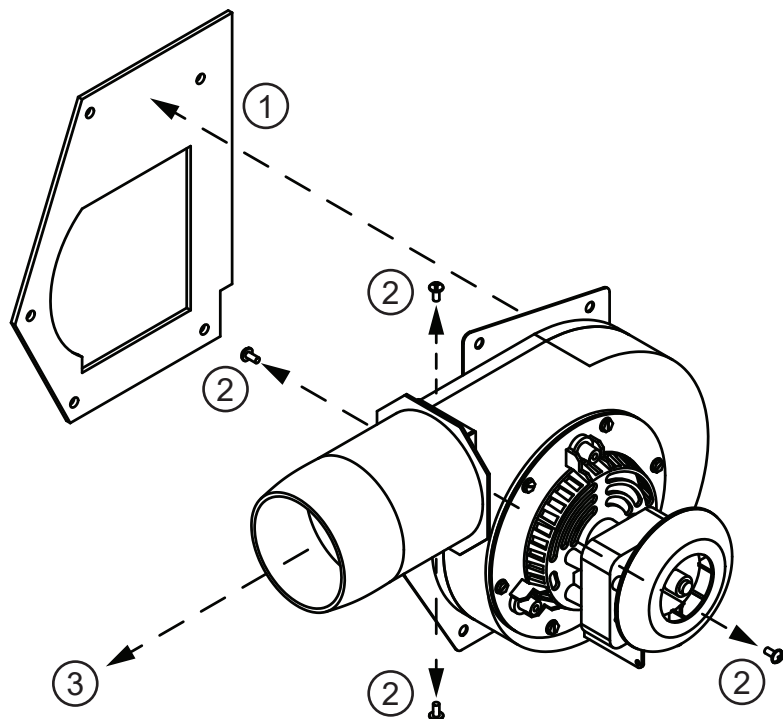

- ① REMOVE THE EXHAUST FAN GASKET.
- ② USING A #2 ROBERTSON SCREWDRIVER, REMOVE THE 4 SCREWS SECURING THE EXHAUST TUBE ASSEMBLY TO THE FAN.

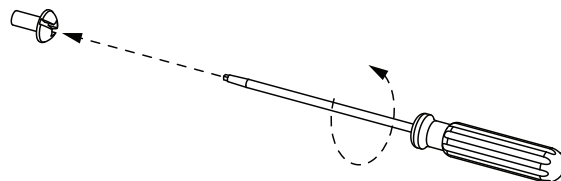

- ③ REMOVE EXHAUST TUBE ASSEMBLY.

12

SILICONE THE EXHAUST TUBE ASSEMBLY TO THE NEW FAN. SECURE THE EXHAUST TUBE ASSEMBLY WITH THE 4 SCREWS AS SHOWN BELOW.

SEAL INNER
EDGE WITH HIGH
TEMPERATURE
SILICONE

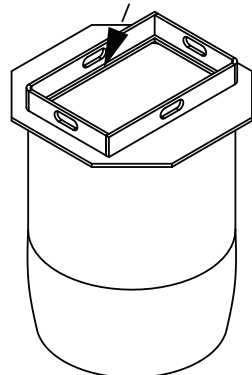

SEAL OUTER
EDGES OF
EXHAUST
FAN OPENING
WITH HIGH
TEMPERATURE
SILICONE

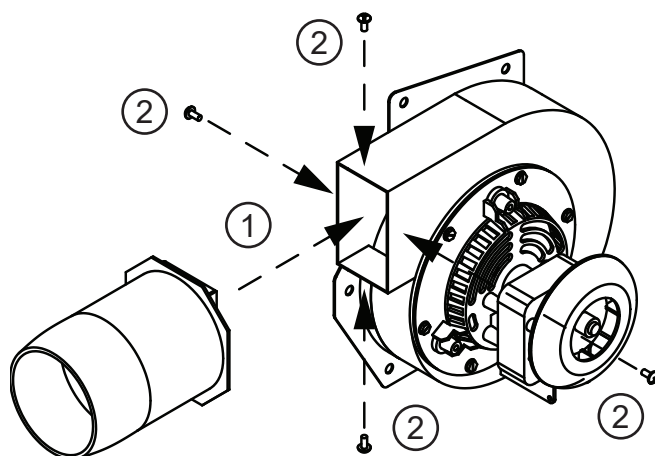
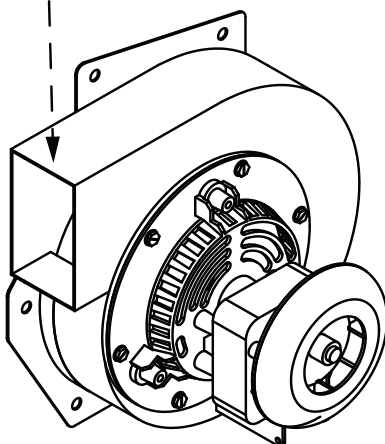

- ① PUSH THE EXHAUST TUBE ASSEMBLY ONTO FAN OPENING.
- ② SECURE TUBE ASSEMBLY TO EXHAUST FAN WITH 4 SCREWS.

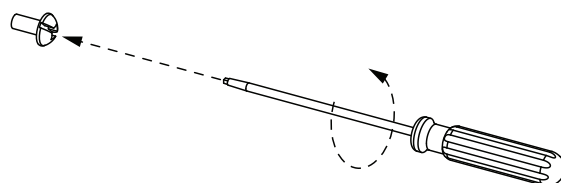

13

SECURE THE NEW EXHAUST FAN ASSEMBLY AND GASKET TO THE STOVE AS SHOWN BELOW.

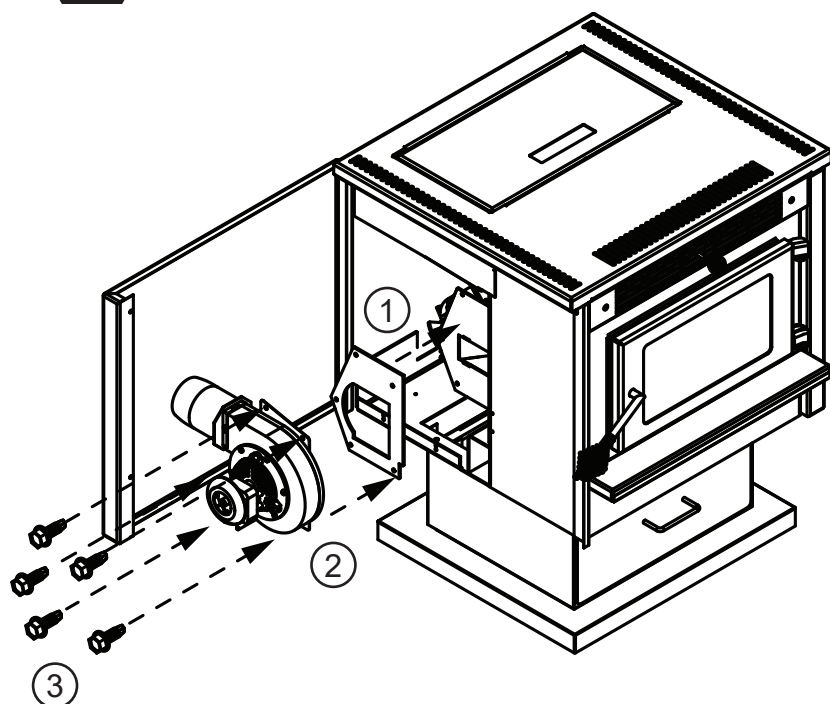

- ① PLACE EXHAUST FAN GASKET ON EXHAUST BOX.
- ② PLACE EXHAUST FAN ON GASKET. LINE UP THE HOLES OF THE FAN AND GASKET TO THE HOLES ON THE EXHAUST BOX.
- ③ SECURE FAN ASSEMBLY AND GASKET TO THE EXHAUST BOX WITH 5 BOLTS.

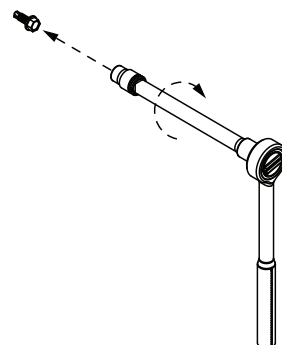

14

CONNECT THE EXHAUST FAN WIRES TO THE MAIN WIRING HARNESS OF THE PELLET STOVE AS SHOWN BELOW.

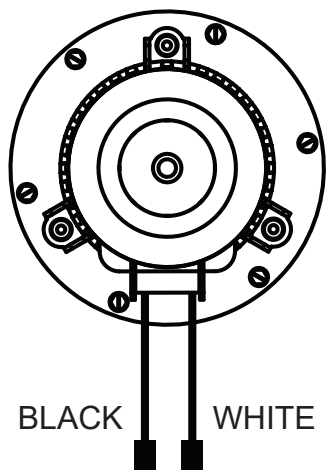

BLACK WHITE

BLUE WHITE

MAIN HARNESS

MX OR MX2 CONTROL BOARD

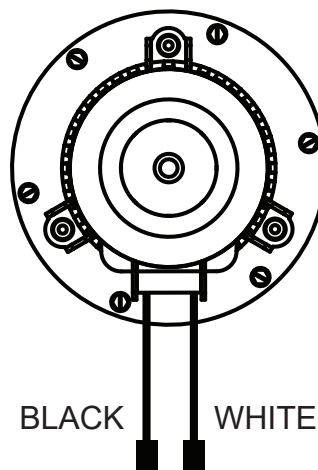

BLACK WHITE

RED WHITE

MAIN HARNESS

STANDARD CONTROL PANEL

15

SECURE THE BACK PLATE TO THE REAR OF THE STOVE AS SHOWN BELOW.

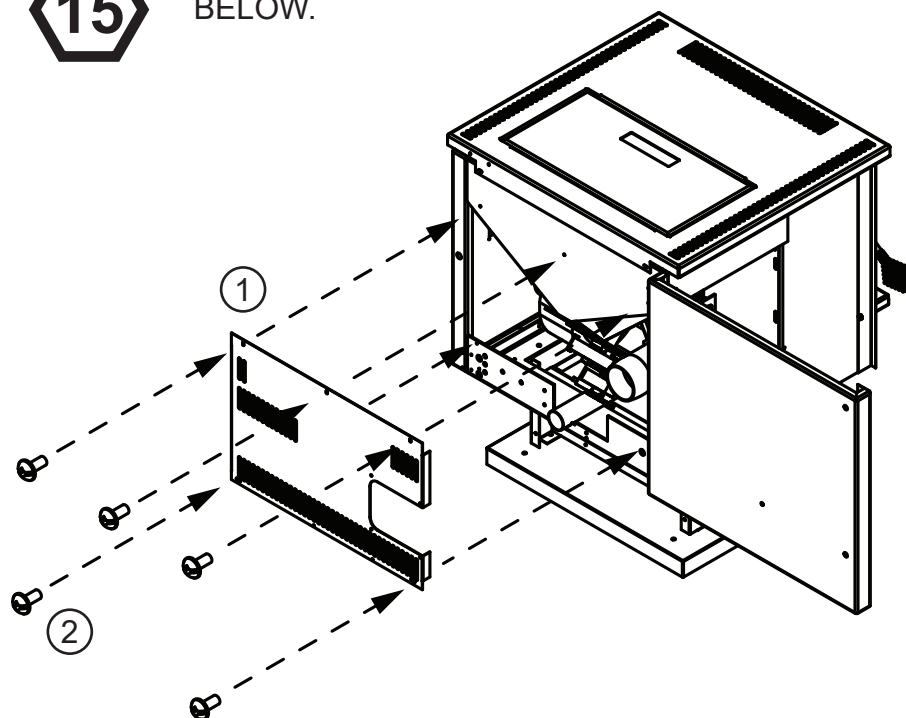

① PLACE BACK PLATE ONTO REAR OF PELLET STOVE.

② SECURE BACK PLATE TO THE PELLET STOVE WITH 4 SCREWS.

CLOSING THE LEFT SIDE PANEL:

16

PLACE THE DAMPER ROD IN THE HOLE OF THE SIDE PANEL AND CLOSE THE SIDE PANEL. ONCE THE SIDE PANEL IS CLOSED, PUSH THE DAMPER ALL THE WAY IN.

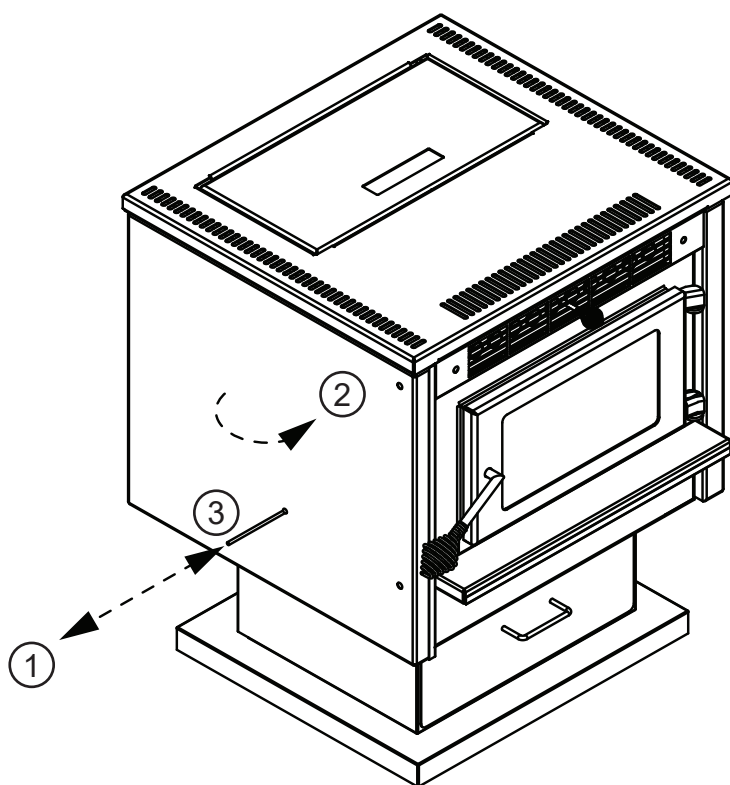

① ENSURE THAT THE DAMPER ROD IS PLACED THROUGH THE SIDE PANEL HOLE AND PULLED ALL THE WAY OUT.

② SHUT THE LEFT SIDE PANEL CLOSED.

③ PUSH DAMPER ROD ALL THE WAY IN.

17

SECURE THE SIDE PANEL WITH 2 SCREWS AS SHOWN BELOW. ONCE THE SIDE PANEL IS CLOSED, PUSH THE DAMPER COIL HANDLE ON THE DAMPER ROD AS SHOWN BELOW.

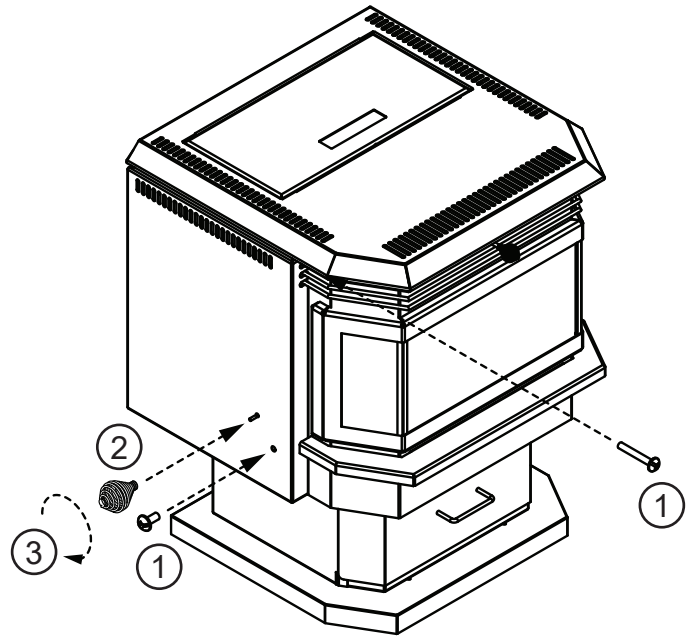
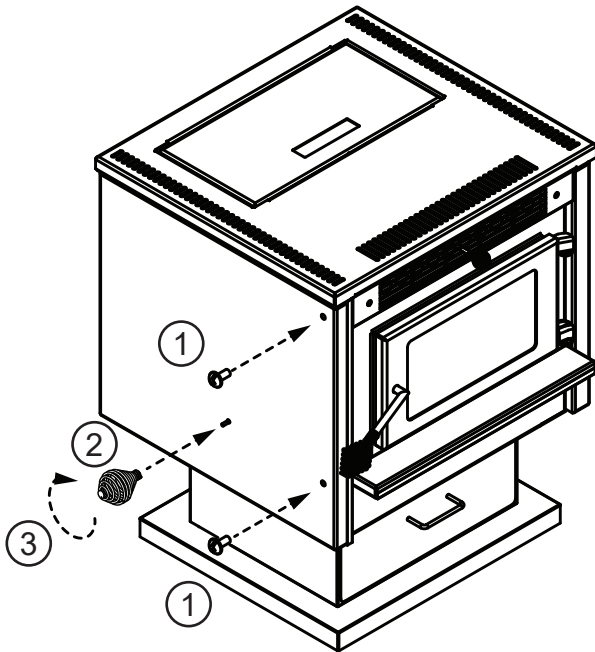

- ① SECURE THE SIDE PANELS WITH THE SCREWS AS SHOWN. USE A #2 ROBERTSON SCREWDRIVER TO SECURE THE SCREWS.

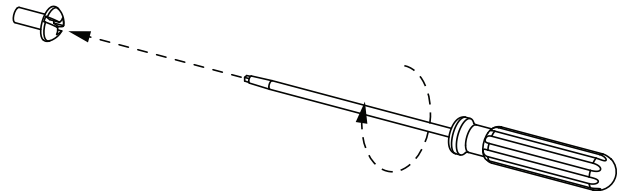

- ② FULLY CLOSE THE DAMPER.

- ③ PUSH THE SPRING COIL HANDLE ONTO THE DAMPER ROD. ROTATE THE DAMPER COIL CLOCKWISE AND PUSH SIMULTANEOUSLY TO SECURE THE COIL TO THE ROD.

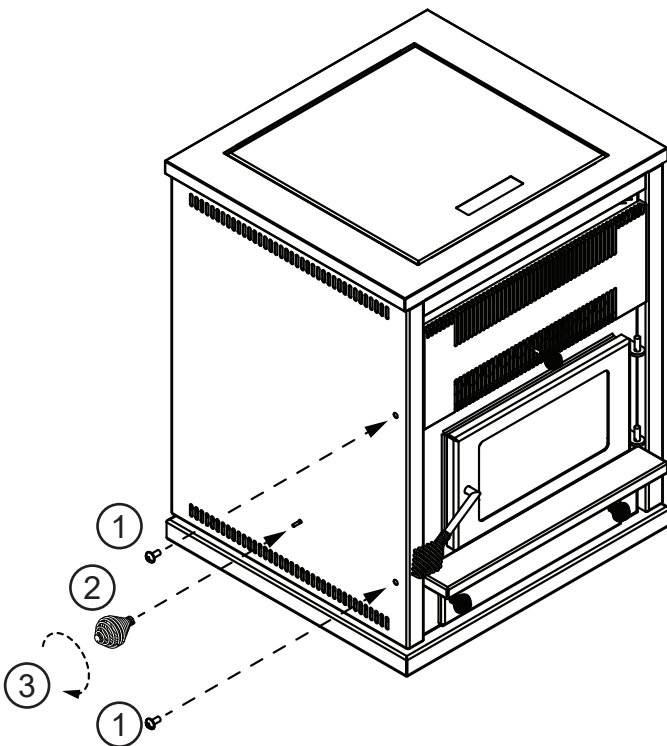

KOZI (Division of APR Industries Ltd.)

1354 Waverley Street, Winnipeg, Manitoba, Canada, R3T 0P5

Phone: (204) 452-9907, Fax: (204) 453-2747

Email: mail@kozistoves.com, Website: www.kozistoves.com